

Détail 1:1 barre de charge occulte Ø20

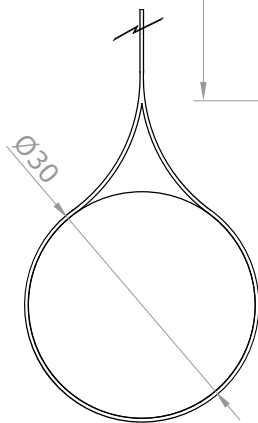

Détail 1:1 barre de charge occulte Ø30

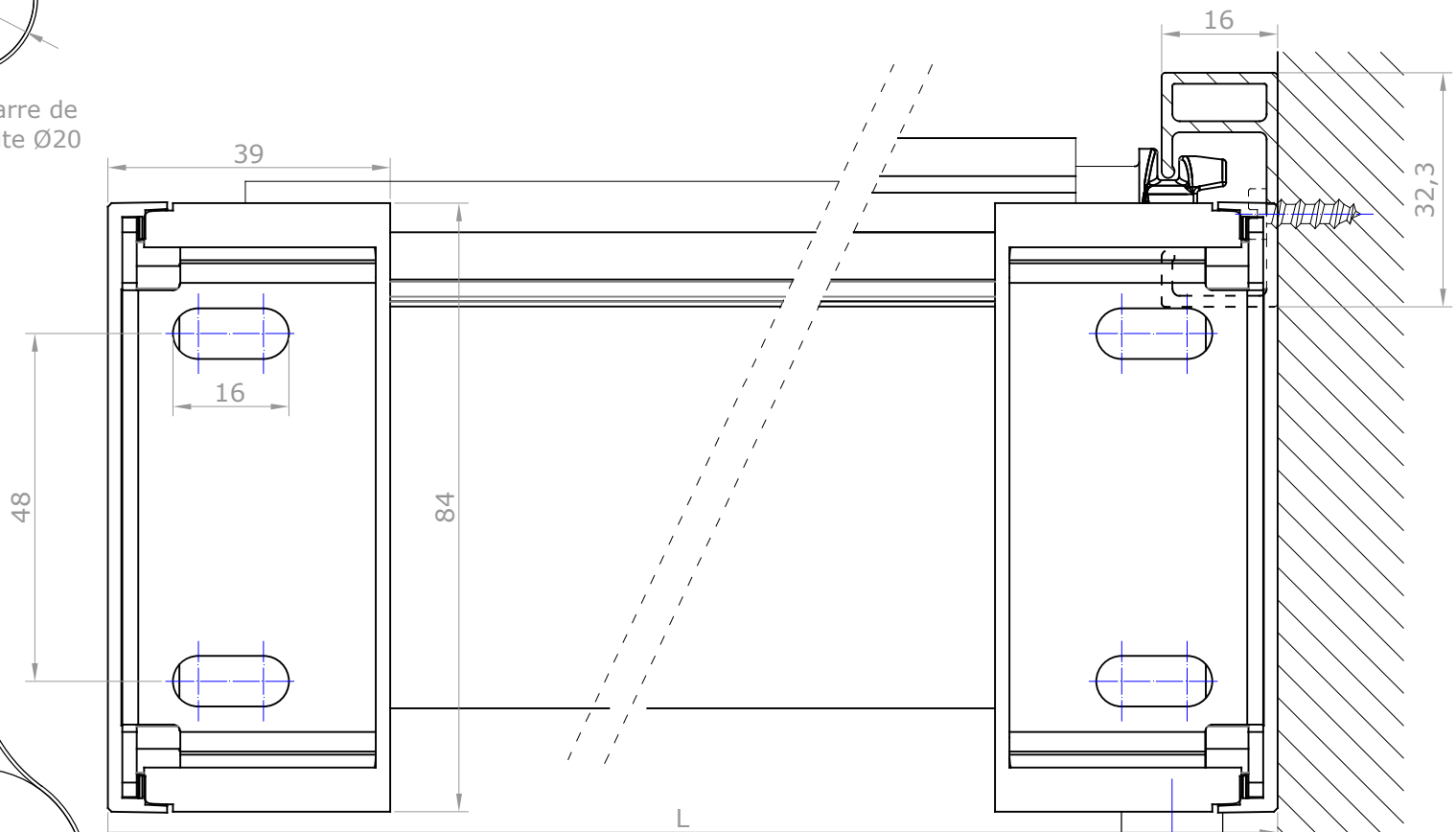
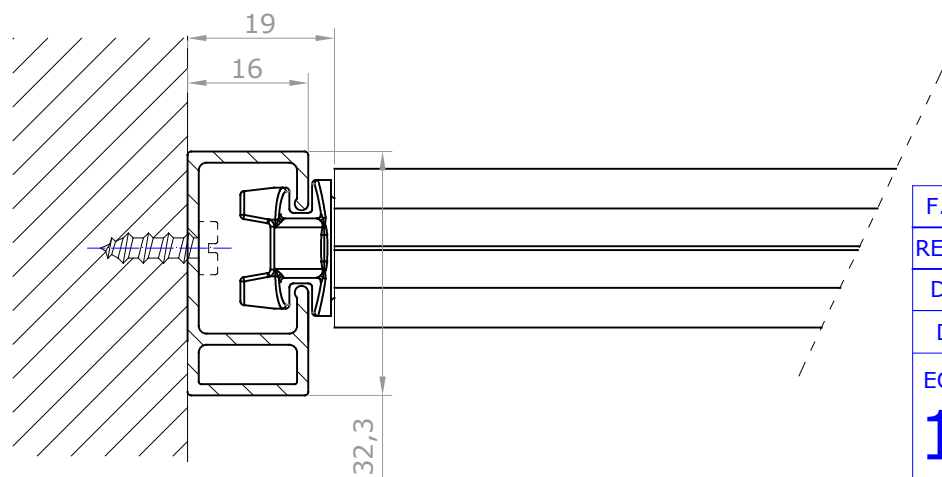

F. REVIS.			
REVISION	123456789	BANDALUX	
DATE	13-02-2018	PLAN N°	
DESSIN	Miquel P.	FORMAT	A-3
ECHELLE	Store enrouleur Premium Plus II Manivelle coulisses U-301 Installation: pose au plafond, installation latérale Mécanisme: Manivelle Barre de charge: Occulte de Ø20mm Tube Ø55mm		
1/1			

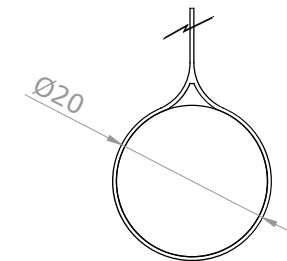
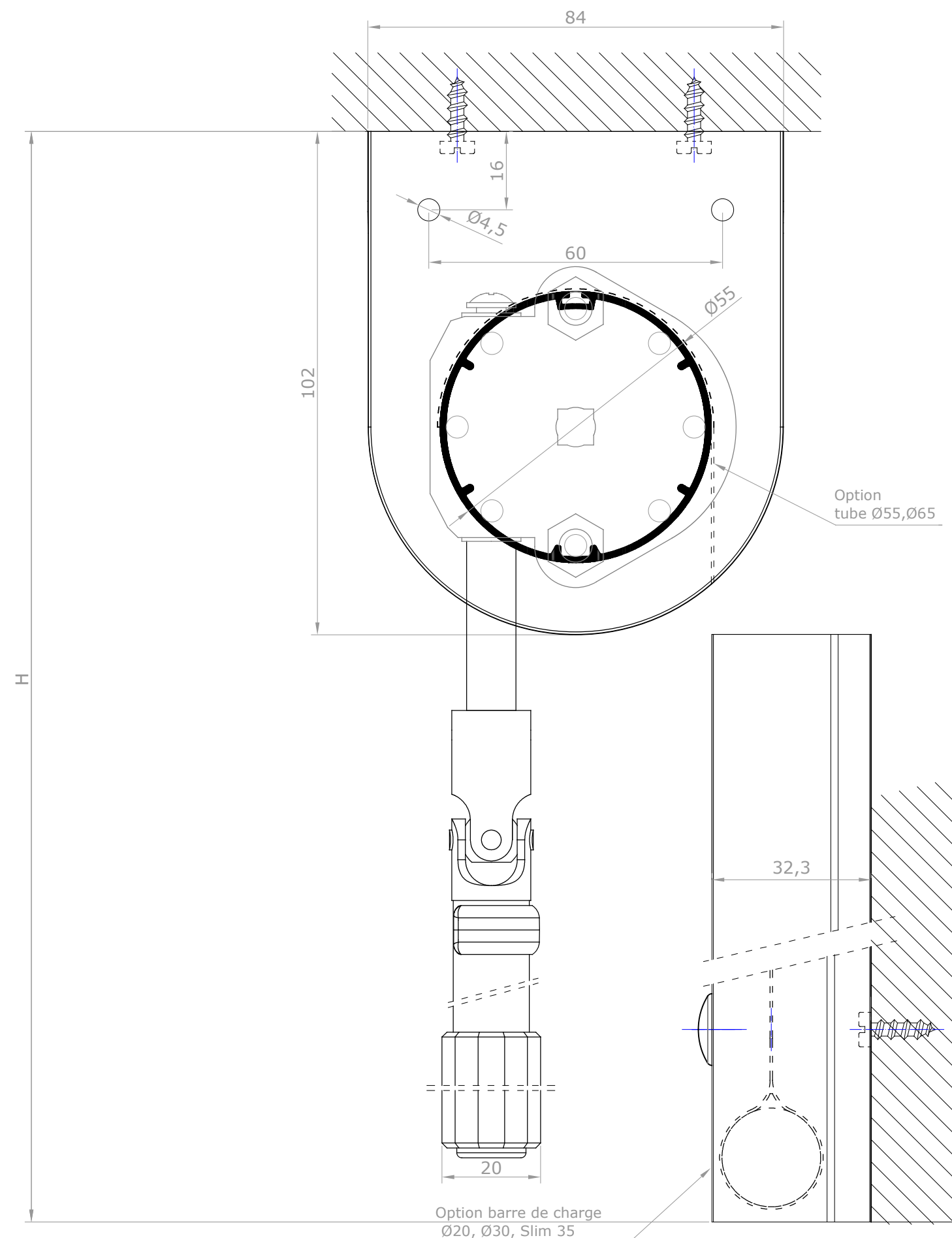

Détail 1:1 barre de charge occulte Ø20

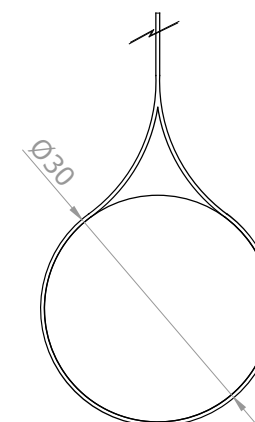

Détail 1:1 barre de charge occulte Ø30

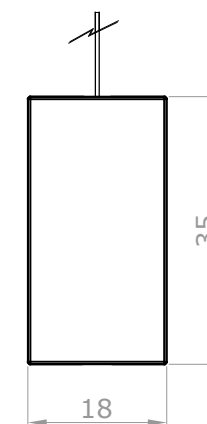

Détail 1:1 barre de charge apparente Slim 35

F. REVIS.		BANDALUX	
REVISION	1 2 3 4 5 6 7 8 9		
DATE	13-02-2018	PLAN N°	
DESSIN	Miquel P.	FORMAT	A-3
ECHELLE	Store enrouleur Premium Plus II Manivelle coulisses U-301 Installation: pose au plafond, installation frontale Mécanisme: Manivelle Barre de charge: Occulte de Ø20mm Tube Ø55mm		
1/1			

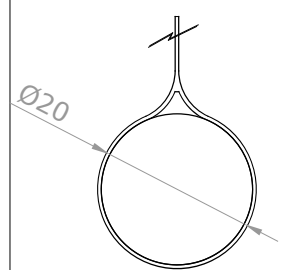

Technical drawing of a 2x2 plate assembly. The drawing shows two plates, each with two oval-shaped holes. The dimensions are as follows:

- Overall width: 39
- Overall height: 48
- Distance between the centers of the two holes on a single plate: 16
- Distance between the centers of the two plates: 84
- Overall length: L

The drawing includes a section line (dashed line) indicating a cut through the assembly. The text "re de" and "te Ø20" is visible in the top left corner.

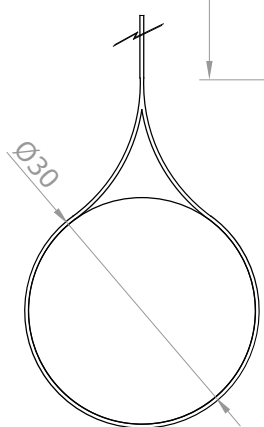

Technical drawing of a screw anchor (F. 1) showing a side view. The anchor is installed in a concrete wall. Dimensions are given in mm: total height 32,3, width 16, and base width 19. A hole diameter of Ø30 is indicated at the top.

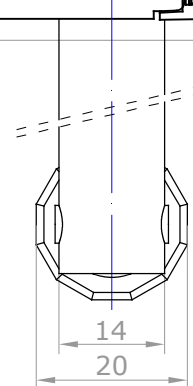

F. REVIS.		BANDALUX	
REVISION	123456789		
DATE	13-02-2018	PLAN N°	
DESSIN	Miquel P.	FORMAT	A-3
ECHELLE 1/1	Store enrouleur Premium Plus II Manivelle coulisses U-301 Installation: pose au plafond, installation frontale Mécanisme: Manivelle Barre de charge: Occulte de Ø20mm Tube Ø55mm		

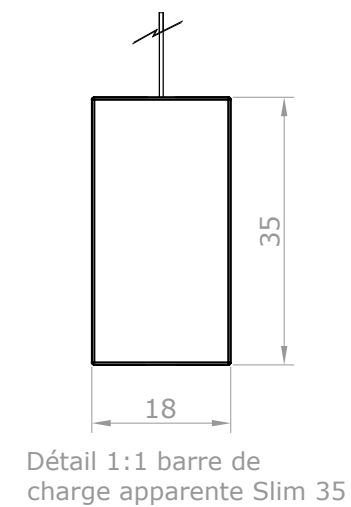
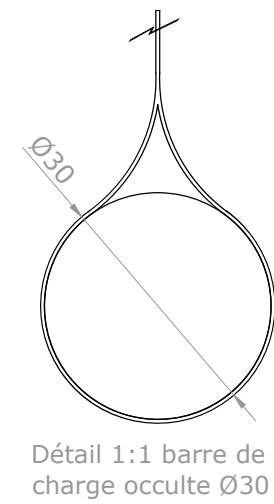
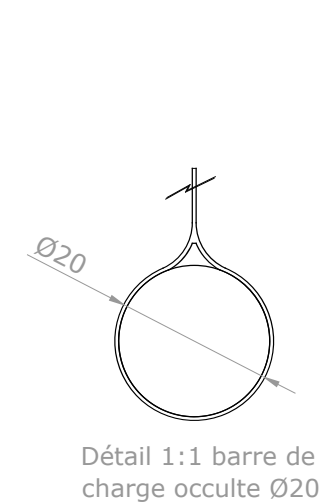
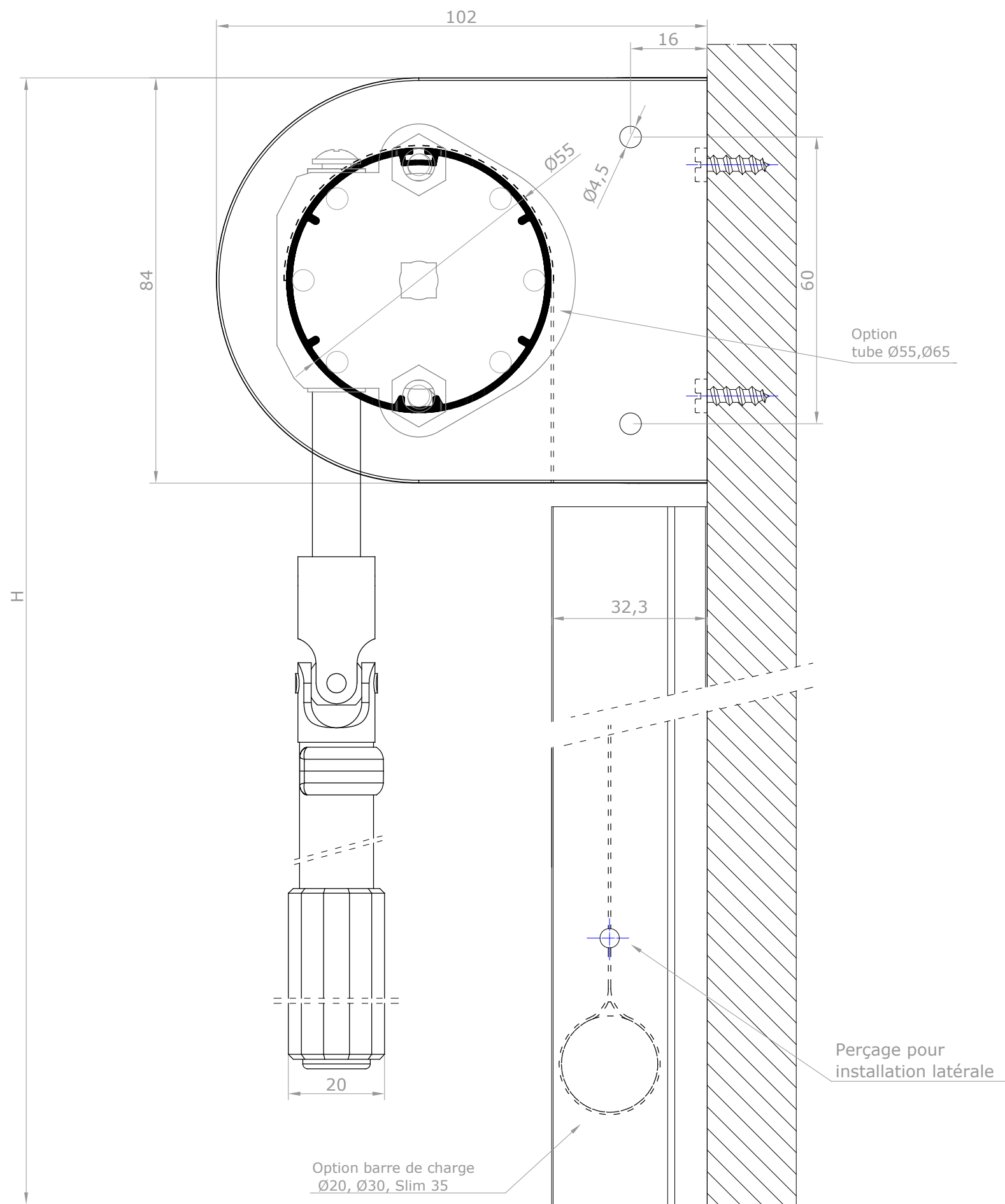

F. REVIS.		BANDALUX	
REVISION	1 2 3 4 5 6 7 8 9		
DATE	13-02-2018	PLAN N°	
DESSIN	Miquel P.	FORMAT	A-3
ECHELLE	Store enrouleur Premium Plus II manivelle coulisses U-301 Installation: pose en façade, installation latérale Mécanisme: Manivelle Barre de charge: Occulte de Ø20mm Tube Ø55mm		
1/1			

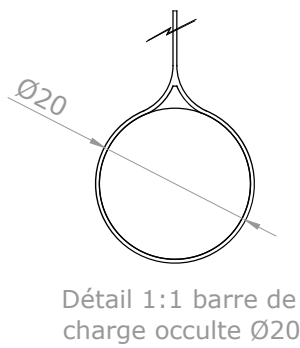
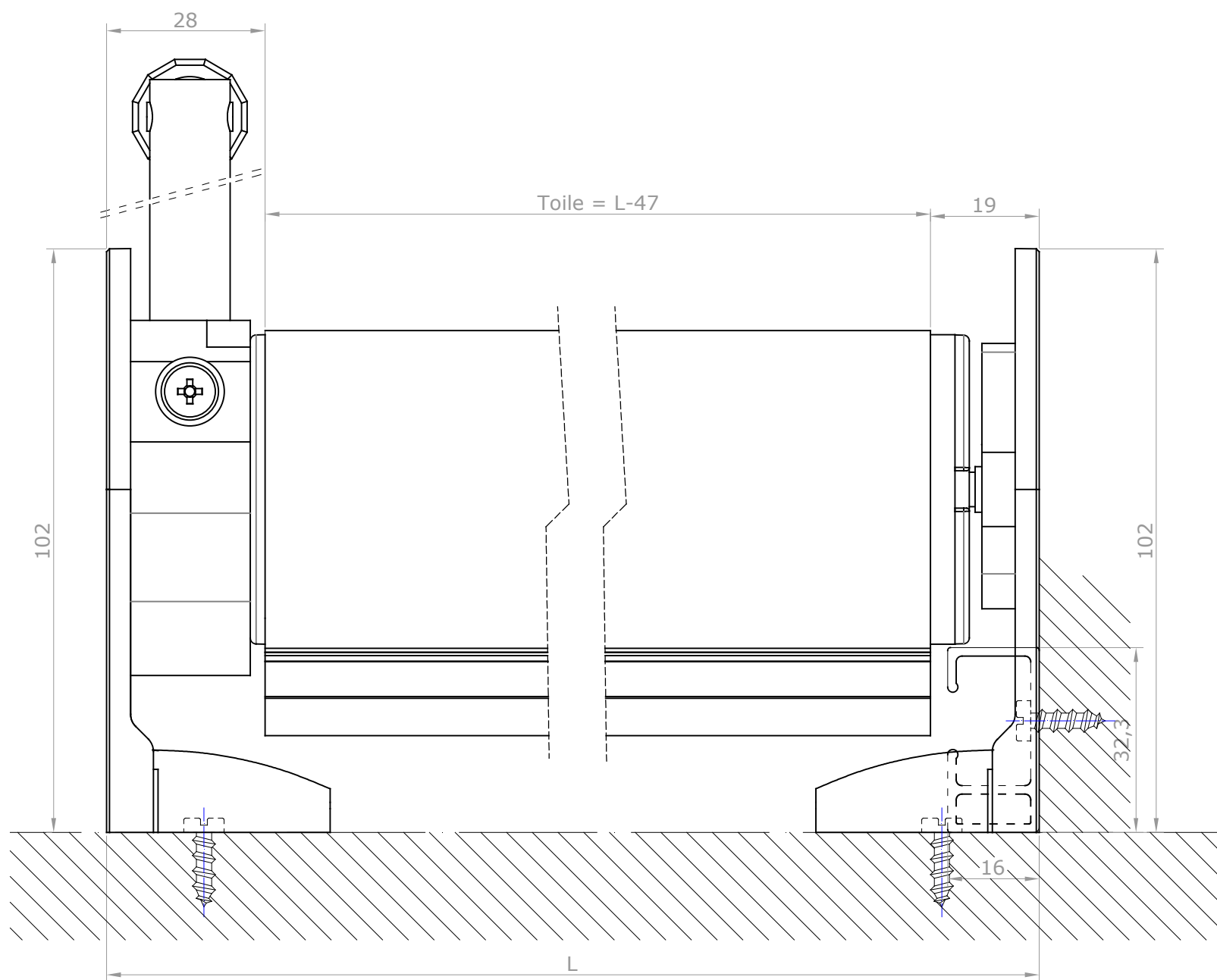
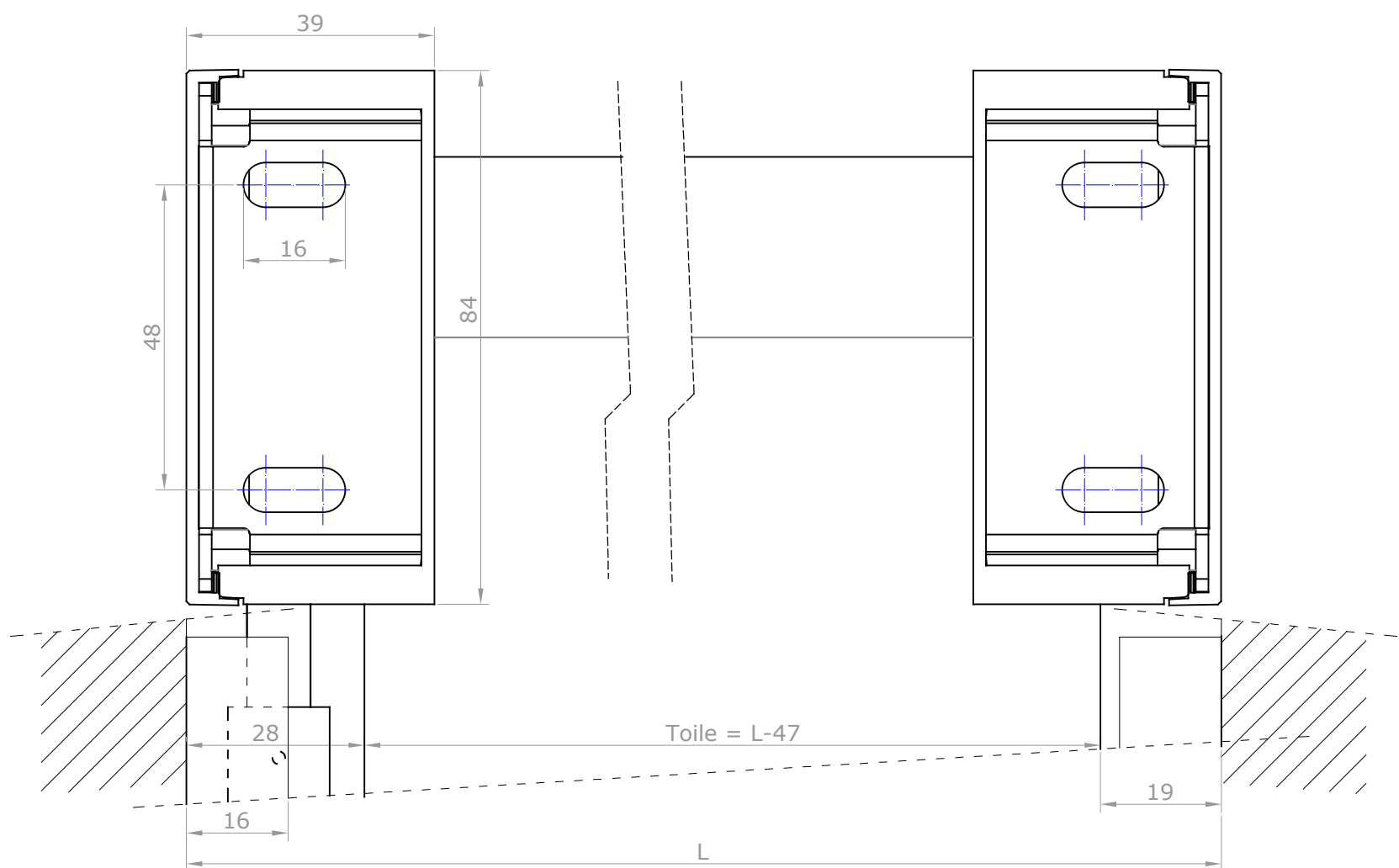

Détail 1:1 barre de charge occulte Ø20

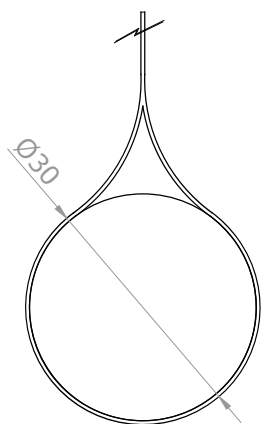

Détail 1:1 barre de charge occulte Ø30

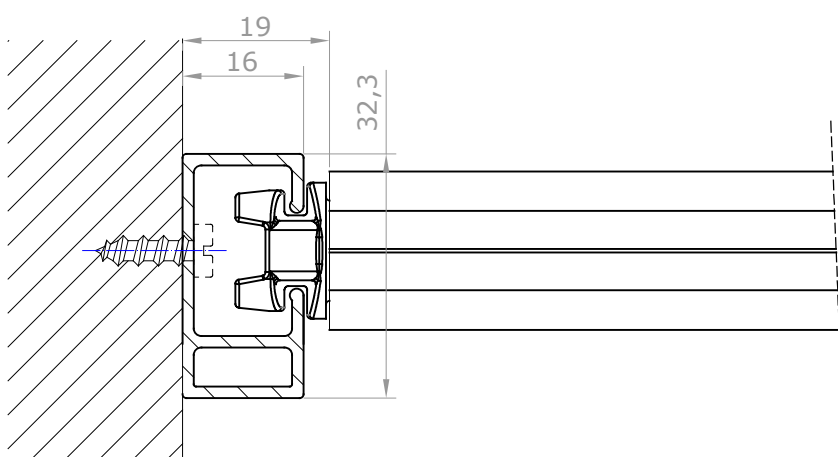

F. REVIS.		BANDALUX	
REVISION	123456789		
DATE	13-02-2018	PLAN N°	
DESSIN	Miquel P.	FORMAT	A-3
ECHELLE	Store enrouleur Premium Plus II manivelle coulisses U-301 Installation: pose en façade, installation latérale Mécanisme: Manivelle Barre de charge: Occulte de Ø20mm Tube Ø55mm		
	1/1		

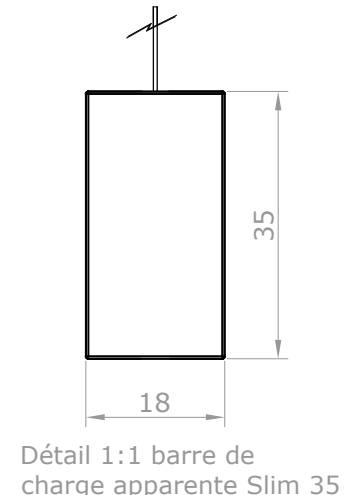
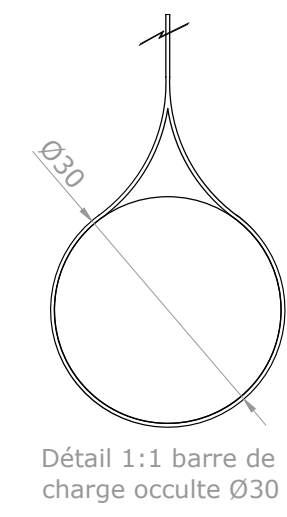
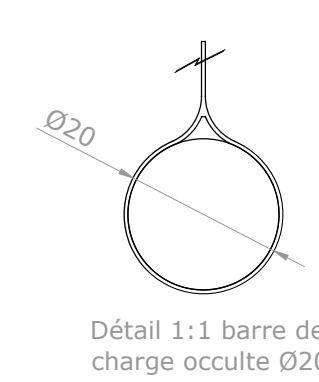
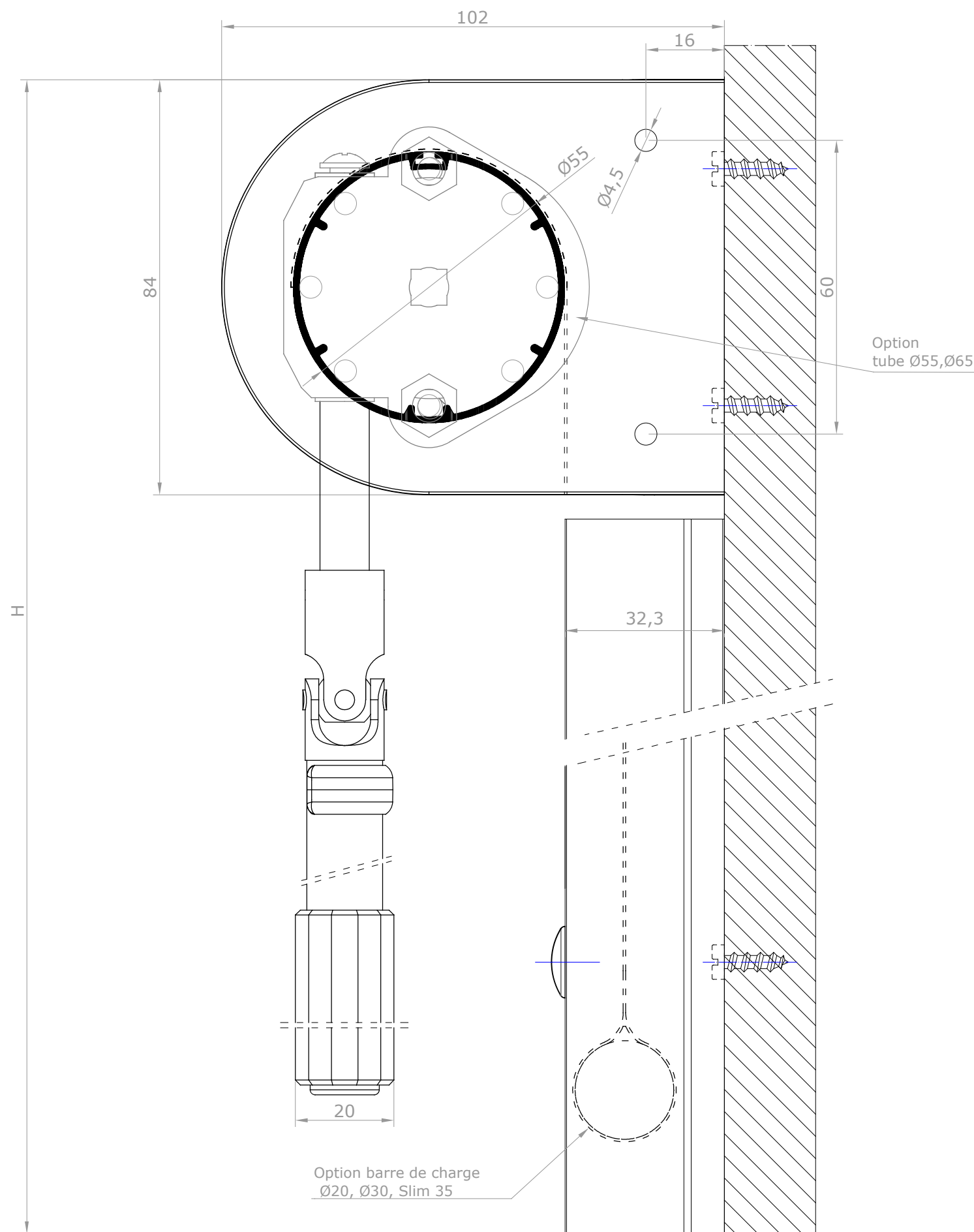

F. REVIS.		BANDALUX	
REVISION	123456789		
DATE	13-02-2018	PLAN N°	
DESSIN	Miquel P.	FORMAT	A-3
ECHELLE	Store enrouleur Premium Plus II Manivelle coulisses U-301 Installation: pose en façade, installation frontale Mécanisme: Manivelle Barre de charge: Occulte de Ø20mm Tube Ø55mm		
1/1			

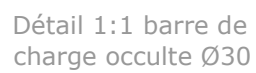
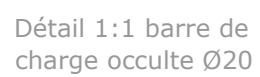
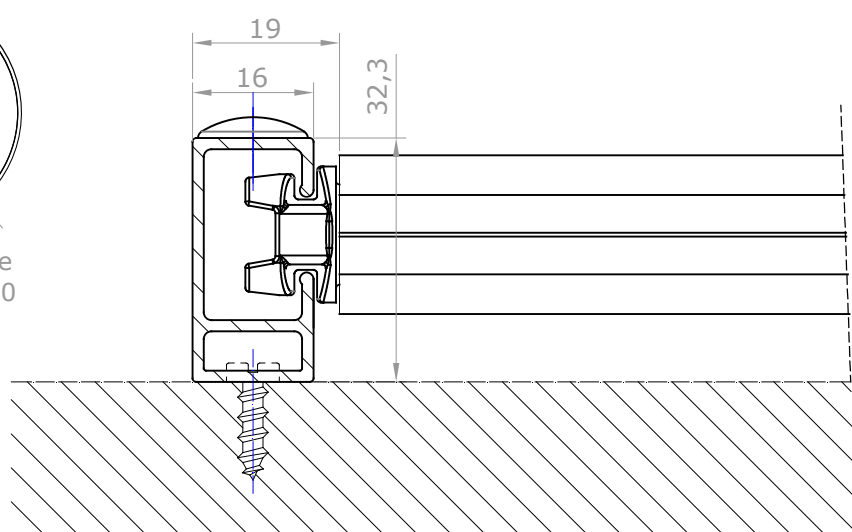

F. REVIS.		BANDALUX	
REVISION	123456789		
DATE	13-02-2018	PLAN N°	
DESSIN	Miquel P.	FORMAT	A-3
ECHELLE 1/1	Store enrouleur Premium Plus II Manivelle coulisses U-301 Installation: pose en façade, installation frontale Mécanisme: Manivelle Barre de charge: Occulte de Ø20mm Tube Ø55mm		